

M-16iB™ Series

Basic Description

The M-16iB series is a six-axis, modular construction, electric servo-driven robot designed for a variety of industrial applications. Based on its simple and reliable construction, the M-16iB series provides sophisticated motion control and consistent performance with high productivity. The SYSTEM R-J3iB Controller and easy-to-use HandlingTool application software provide accurate and consistent path performance.

The M-16iB series, the latest generation material handling robot, has a compact design with improved motion range and speed. The compact yet flexible design simplifies installation, maximizes reach capability within confined areas and enables high-density installation of robots and peripherals.

M-16iB Series, the Solution for:

- Assembly
- Dispensing
- Material handling
- Machine load/unload
- Material removal
- Waterjet cutting
- Laser cutting
- Packing

Benefits

- Largest work envelope and load capacity in its class allows robot operation in a wide range of high-speed, medium-payload manufacturing processes.
- No robot modification required for upright, inverted, angle and wall mounting.
- Unique hollow RV speed reducers simplify cable routing.
- Small footprint facilitates placement in tight surroundings.
- Low arm mass and rigid design allow high-speed, precise positioning.

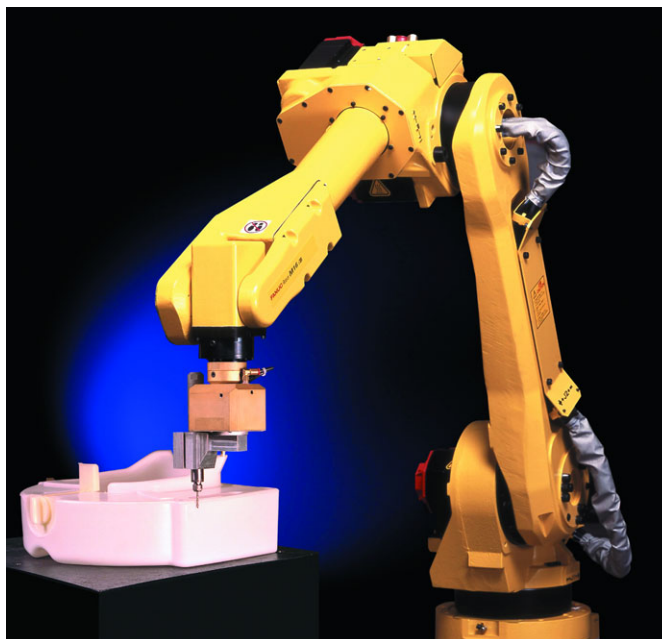

- Dedicated pneumatic and electrical (with eight digital inputs and eight digital outputs) connections on J3 axis to simplify user's end-of-arm tooling design, integration and communication.
- Material handling style teach pendant with large LCD screen and ergonomic design offers intuitive control over the process.
- Fail-safe brakes on all axes increase safety, functionality and control.

Features

- Repeatability of +/- 0.08 mm at full speed and full payload within entire work envelope.
- 20 kg payload capacity.
- Axes speeds up to 520 degrees/sec. Best in its class.
- "Double-jointed" arm increases work envelope and positioning flexibility.
- Absolute serial encoders eliminate the need for calibration at power-up.

Reliability Features

- Sealed bearings and drives, and brushless AC motors minimize maintenance.
- Grease fittings on all lubrication points for quick and easy maintenance.

- Uses directly-coupled drives, which are more reliable than belts, pulleys or chains.
- All motors, cables and tooling services are engineered to prevent snagging and damage from chips, sprays and other hazards.
- Dust and water resistant design maximizes durability.
- Quick disconnect robot connecting cables.
- In-line wrist design minimizes complexity and eliminates bevel gear adjustments.

Options

- 360° Axis 1 base rotation.
- Severe dust and liquid protection package for harsh environment applications (standard M-16iB wrist is rated IP67 to withstand temporary immersion in liquids).
- iPendant, a color, Internet-ready teach pendant for even easier programming and custom cell user interface design. iPendant is also available with touch screen support.
- Auxiliary axis packages for integration into part positioners.
- Various robot connection cable lengths for flexible cabinet placement and optional track rated cables.

FANUC
Robotics

M-16iB Series Dimensions

Isometric

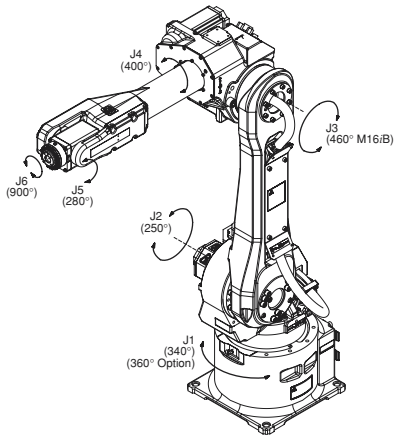

Top

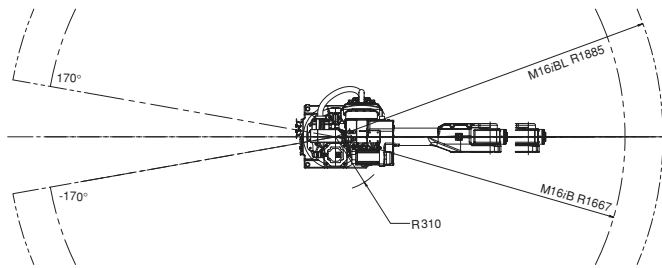

Footprint

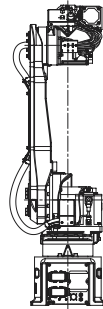
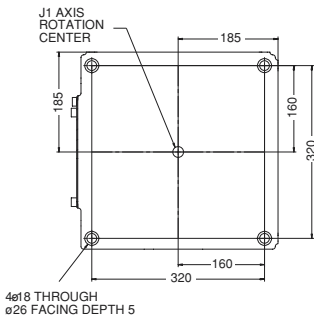

Back

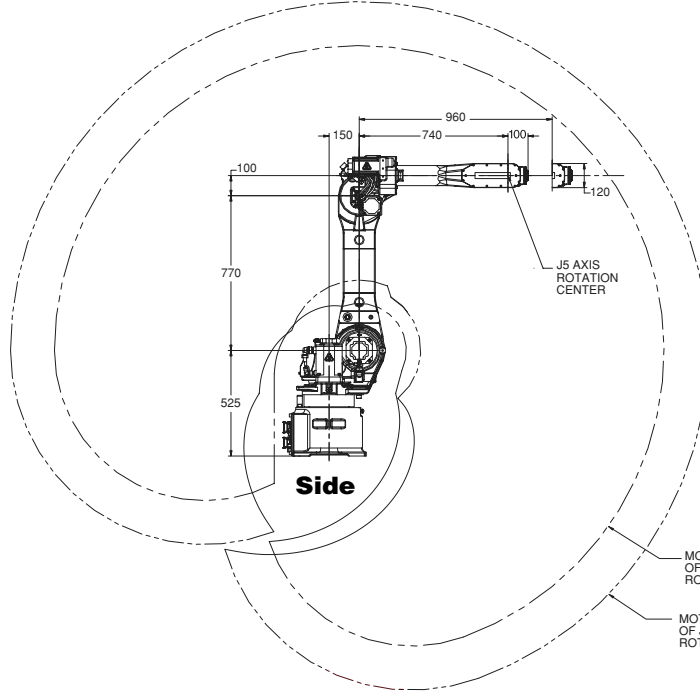

Side

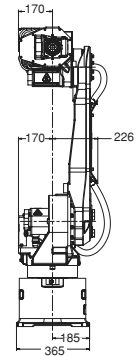

Front

4ø18 THROUGH ø26 FACING DEPTH 5

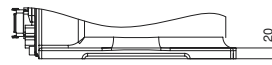

M-16iB Series Specifications

Items	M-16iB/20	M-16iB/10L
Axes	6	6
Payload (kg)	20	10
Reach (mm)	1667	1885
Repeatability (mm)	±0.08	±0.10
Interference radius (mm)	310	310
Motion range (degrees)		
J1	340/360	340/360
J2	250	250
J3	460	455
J4	400	400
J5	280	280
J6	900	900
Motion speed (degrees/sec.)		
J1	165	165
J2	165	165
J3	175	175
J4	350	350
J5	340	340
J6	520	520
Wrist moment (kgf-m)		
J4	4.0	2.2
J5	4.0	2.2
J6	2.0	1.0
Wrist inertia (kgf-cm-s ²)		
J4	9.0	6.4
J5	9.0	6.4
J6	2.5	1.5
Mechanical brakes	All axes	All axes
Mechanical weight (kg)	220	230
Mounting method	Floor, ceiling (angle and wall - see Note 1)	
Installation environment		
Temperature °C	0 to 45	
Humidity	Normally: 75% or less Short term (within a month): 95% or less No condensation	
Vibration (m/s ²) (G)	4.9 or less (0.5G or less)	
IP Rating(s)	Body IP54 std. (IP55 optional) Wrist & J3 arm IP67	
Payload at axis 3 (kg)	12	12

Note 1 - J1 and J2 axis motion range will be derated.

Wrist

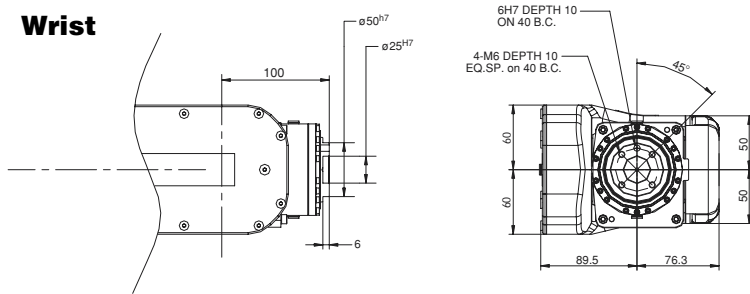

Note: Dimensions shown in millimeters.



FANUC Robotics America, Inc.
3900 W. Hamlin Road
Rochester Hills, MI 48309-3253
(248) 377-7000
Fax (248) 276-4133

Charlotte, NC
 (704) 596-5121

Chicago, IL
 (847) 898-6000

Toronto, Canada
 (905) 812-2300

Montréal, Canada
 (450) 492-9001

For sales or technical information, call:
1-800-47-ROBOT

Cincinnati, OH
 (513) 754-2400

Aguascalientes, Mexico
 52 (449) 910-8000

Los Angeles, CA
 (949) 595-2700

Sao Paulo, Brazil
 (55) (11) 3619-0599

marketing@fanucrobotics.com
www.fanucrobotics.com

Toledo, OH
 (419) 866-0788